

# HIGHWAY AT WALSALL IN THE METROPOLITAN BOROUGH OF WALSALL

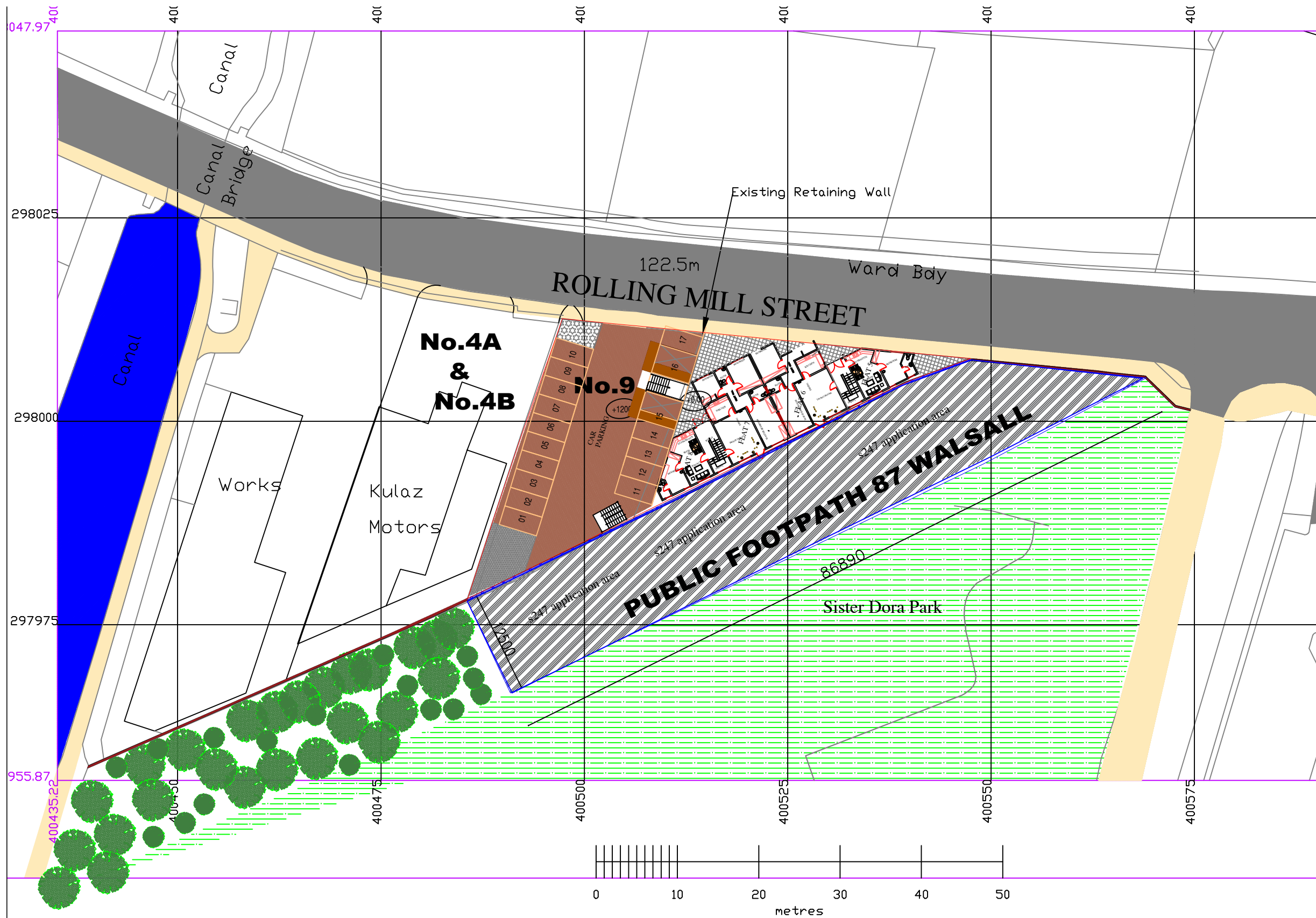

**North**

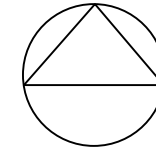

Key Scale 1:500 @ A3

Highway to be stopped up

National Transport Casework Team

Department for Transport

Plan No:  
NATTRAN/WM/S247/5452

Signed by Authority of the Secretary of State

on.....

Signature.....

**TIM BRIMELOW**  
An Official in the  
National Transport Casework Team  
Department for Transport