

# WILLENHALL FRAMEWORK PLAN

## MOAT STREET & VILLIERS STREET DRAFT PROPOSALS

### SITES C AND D, NEW HALL STREET

Sites C and D are located to the north and south of New Hall Street. Site C comprises two areas to the south of New Hall Street, with Site D forming an elongated site along the north of the road.

#### Proposals include:

- Site C would comprise amenity space for use by residents and the wider community. The open space will also enhance the cemetery
- Demolition of existing industrial buildings to the north of New Hall Street
- A new apartment block is proposed within Site D, allowing the creation of up to 12 one and two-bedroom dwellings
- To the western end of Site D, the indicative plan shows a further 8 three-bedroom properties

#### Indicative Layout for Sites C and D, New Hall Street

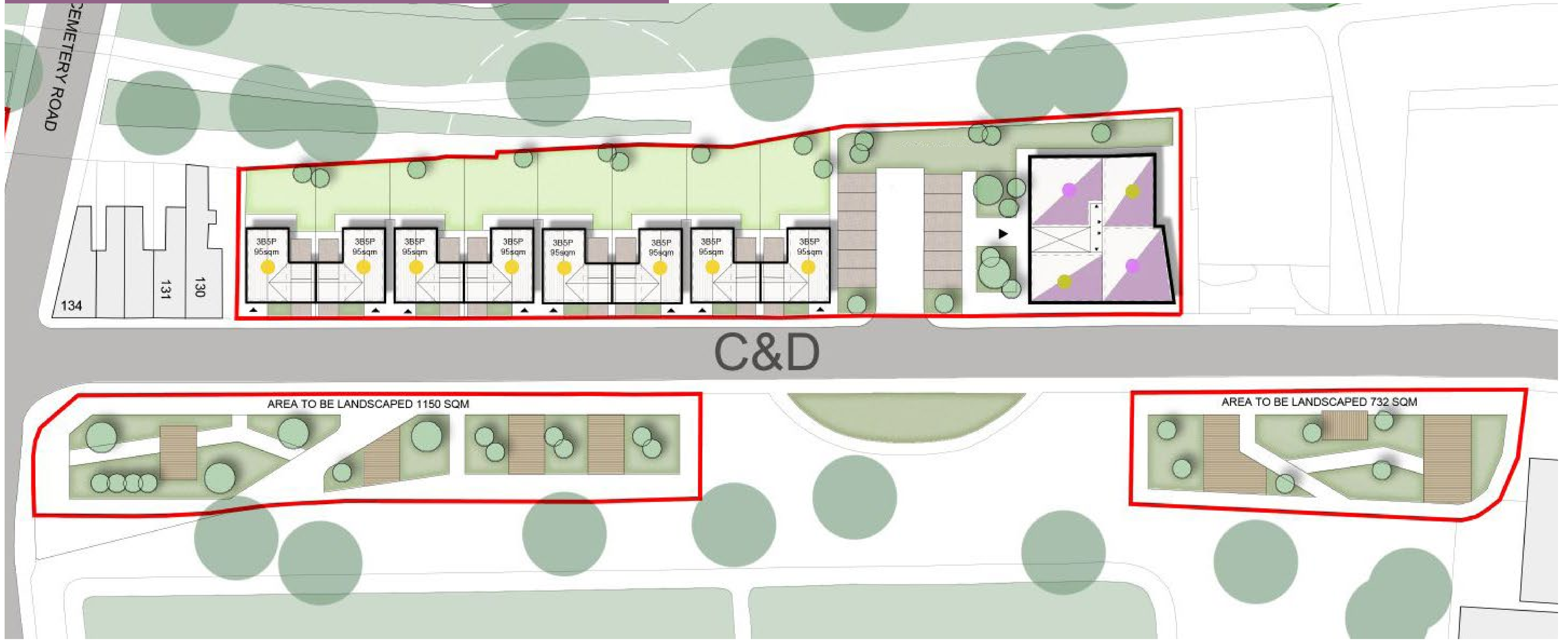

#### Indicative street elevations along New Hall Street

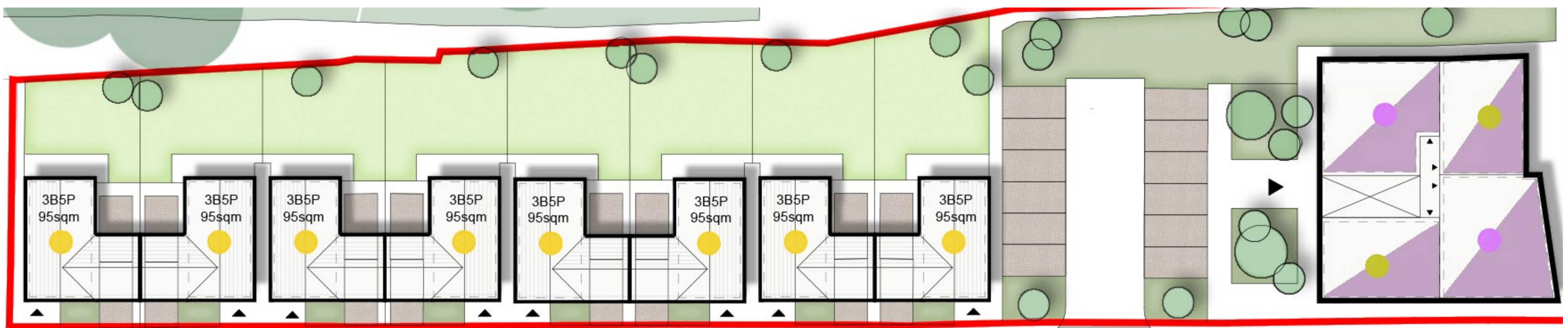

#### Key:

- 3 bedroom house
- 2 bedroom apartments
- 1 bedroom apartments

Note:  
All drawings and site photos are ©ARCADIS unless otherwise stated.



Walsall Council

ARCADIS

