

Birmingham & Black Country Local Sites Assessment Report

EcoRecord Reference	Site Name	Grid Reference	Current Status [1]	Survey Date(s)
N/A	Land at former Goscote Hospital Site	SK 016 017	None	22/08/2019
Planning Authority	Site Ownership	Area/Length	Reason for Survey	Report Date
Walsall	Walsall MBC	6.93ha	BC Call for Sites	07/02/2020

Meets LS Criteria	SLINC	Type	Wildlife	i.e. Wildlife/Geological

Amendment(s)	New Site	i.e. None; New Site; Upgrade; Downgrade; Extension; Whole/Part Deletion
Description	Broadleaved plantation woodland and tall neutral grassland, as denoted on map 1, are deemed to meet the criteria for SLINC status, as such they should be designated as a new site 'Goscote Hospital Woods'.	

Citation (Summary of Value)
The survey site encompasses a working care home with associated hard standing and managed and naturalised habitat, including broadleaved plantation woodland, scattered parkland trees, neutral grassland, and amenity grassland. These habitats are focused along the peripheries and separating areas of hard standing. Overall, the site is of ecological value providing an edge to adjacent designated waterways and has good connectivity to Mill Lane (LNR) and Park Lime Pits (SINC). Of particular interest is the plantation woodland that has developed semi-natural features, and the tall neutral grassland with tussocks and anthills present. Therefore, these areas highlighted on map 1 are recommended for designation.

Local Site Selection Criteria		
Ecological		
Habitat Diversity	M	The site supports a good mix of common habitat types each with some structural variation: broadleaved woodland plantation, scattered trees, scrub, neutral grassland, and hedgerows. Furthermore, onsite buildings provide additional habitat for bats. However, large areas of amenity grassland are of limited ecological value and diversity.
Species Diversity	M	A good range of native woody and vascular species are present across the site, particularly in the woodland and neutral grassland. Other areas of the site contain a mix of native and non-native species.
Habitat Rarity	L	The habitat types onsite are <i>Frequent</i> across Birmingham and The Black Country. Hedgerows are listed as a Habitat of Principal Importance however they lack native species diversity and are not considered good examples.
Species Rarity	L-M	The flora and fauna species recorded onsite range from <i>Frequent</i> to <i>Uncommon</i> , two of the recorded species are axiophytes in Birmingham and The Black Country.
Size or Extent	L	In the context of Walsall Local Sites, the survey area is of 'medium' extent, however, a large portion of the site comprises of hard standing and buildings of limited ecological importance, with the majority of its known ecological features being located along the site's peripheries.
Naturalness	L-M	Due to the site's management and planting the naturalness of the majority of the site is low. However, the woodlands and neutral grassland add natural features.
Position & Connectivity	H	The survey area shares its eastern border with the Wyrley and Essington Canal and Goscote Wedge SLINCs, which connect the site to the wider landscape through known Wildlife Corridors.
Geological		
Not Assessed.		
Social		
Historical & Cultural	L	The site formed part of Goscote Hall Estate with little being present onsite before the Hospital Grounds in 1930.
Access	L	The site is not open to the public and does not contain any public rights of way.
Aesthetic	M	Although the site is managed for amenity purposes the woodland and grassland adjacent to the canal boundary add to the aesthetic of this green corridor.
Recorded History	L	There are no previous surveys or ecological records available for the site.
Value for Learning	L	Due to the site's use and privacy, education events would not be suitable.

Site Description

Land at Former Goscote Hospital site is 6.93ha in size and currently identified as a Potential Site of Importance (PSI). It lies to the east of Bloxwich and borders the Wyrley and Essington Canal Site of Importance for Local Nature Conservation (SLINC), as well as the Goscote Wedge SLINC. It also lies within 2km of numerous other PSIs and has links to surrounding Wildlife Corridors which connects the site to the wider landscape, including Mill Lane Local Nature Reserve (LNR) and Park Lime Pits Site of Importance for Nature Conservation (SINC).

Historically the survey area and surrounding land was heathland, more recently the Black Country Historic Landscape Characterisation predominantly describes the area as a settlement with houses present in the mid-1700s; collieries were present in the Goscote area, with Coals Pool positioned to the south of the survey area. The survey area itself was formerly part of Goscote Hall estate and shows nothing of historical or cultural interest until the appearance of the Hospital and associated woodland in the 1930s.

The site supports a range of heavily managed and naturalised habitat types. Heavily managed grassland and planted scattered parkland trees surround the buildings which are currently in use as part of the care facilities. The site boundaries, particularly the north and east, are dominated by less intensively managed habitats, broadleaved woodland and neutral grassland, which have been allowed to undergo succession and develop natural features.

Goscote Hospital and its grounds is closed to the public, therefore the onsite habitats are likely undisturbed.

Habitats

Phase 1 Name	Broadleaved woodland – plantation, Broadleaved tree – planted, Coniferous tree – planted, Parkland – Broadleaved	Phase 1 Code	A112, A112i, A122i, A31
<p>Broadleaved woodland plantation forms the northern boundary of the site. Compartment 2 is predominantly Beech <i>Fagus sylvatica</i> and Wild Cherry <i>Prunus avium</i> woodland with an understory of Holly <i>Ilex aquifolium</i>, Elder <i>Sambucus nigra</i> and Rose <i>Rosa sp.</i> The field-layer includes the axiophyte False-brome <i>Brachypodium sylvaticum</i> which indicates the age and semi-natural structure of the woodland as it was planted in the 1930s during construction of the hospital. Additional field-layer species are Bluebell <i>Hyacinthoides non-scripta</i>, Ivy <i>Hedera helix</i> and Hedge woundwort <i>Stachys sylvatica</i>. Within this woodland, there are areas of bare earth and brash piles adding the structure of the woodland. Target note TN006 denotes a line of Sycamore <i>Acer pseudoplatanus</i> and Horse Chestnut <i>Aesculus hippocastanum</i> trees that run along a fenced road edge, with the field-layer being dominated by competitive species, Cocks-foot <i>Dactylus glomerata</i> and Common Nettle <i>Urtica dioica</i>. In this corner set back from the line of trees is a section of approximately eight planted semi-mature coniferous trees, including Spruce <i>Picea sp</i> and Scots Pine <i>Pinus sylvestris</i>.</p> <p>Compartment 4 is an adjoining area of woodland with a canopy of Silver Birch <i>Betula pendula</i>, Norway Maple <i>Acer platanoides</i> and Sycamore with natural regeneration of Ash <i>Fraxinus excelsior</i> and Sycamore, the field-layer has large areas locally dominated by Herb Robert <i>Geranium robertianum</i>, Ivy and Wood Avens <i>Geum urbanum</i>. Target note TN009 highlights an area within this woodland block where the dominating canopy species is now Wild Cherry with an understory of Hawthorn <i>Crataegus monogyna</i> and Hazel <i>Corylus avellana</i>.</p> <p>Scattered parkland trees, individual trees and lines of trees are a dominating habitat present across the entire site (individual trees are target noted). In compartment 5 amongst an area of tall grassland are rows of planted young Birch, Field Maple <i>Acer campestre</i> and Oak <i>Quercus sp.</i> A line of Scots Pine trees follow the roadside forming an edge to compartment 6.</p> <p>Compartment 7 is an area of scattered trees that are beginning to undergo succession. The semi-mature trees include Beech, Wild Cherry, Norway Maple and Rowan <i>Sorbus aucuparia</i>, with natural regeneration of Elder and Sycamore. The field-layer in the southeast corner contains frequent Ivy, Bramble and Herb Robert. However, the scattered trees running along the south west boundary are less mature, causing the field-layer to be more grass dominated. Scattered trees are the dominating habitat in the south west corner of the site surrounding a disused property and area of hard-standing used as a carpark. Frequent species include Norway Maple, Lombardy Poplars <i>populus nigra</i>. 'Italica' and Common Lime <i>Tilia x europaea</i>.</p> <p>Compartment 13 contains an area of mature scattered trees, species mix contains Scots Pine, Wild Cherry, Horse Chestnut, Beech, and Blackthorn <i>Prunus spinosa</i>, which contains a fallen limb acting as fallen deadwood providing additional microhabitat. In the north of the compartment, there is a smaller area of scattered parkland trees dominated by Beech. Compartment 17 has an area of scattered trees dominated by Common Lime.</p>			
Phase 1 Name	Dense Scrub, Dense Bramble Scrub, Scattered Scrub	Phase 1 Code	A21, A21Rf, A22
<p>Scrub is occasionally present across the survey area, being locally dominant in target noted areas. The largest area of scrub comprises compartment 3, it is dominated by Bramble and connects the two areas of plantation woodland. Bramble scrub also dominates the field-layer in parts of the plantation woodland. Another large area of bramble scrub runs along the east boundary on a slight embankment towards the adjacent canal. Other species present amongst the Bramble include Elder, Nettle and Creeping Thistle <i>Cirsium arvense</i>.</p> <p>Compartment 11 contains frequent patches of scattered scrub, dominating species are Broom <i>Cytisus scoparius</i> and Silver Birch saplings. A larger area of mature dense scrub in the east of the compartment is comprised of Wild Cherry, Elder, Beech with Bramble and Broom.</p>			
Phase 1 Name	Neutral Grassland, Amenity Grassland	Phase 1 Code	B2, J12
<p>Heavily managed amenity grassland is an abundant habitat type and is dominated by ubiquitous grass species, with a high grass to forb ratio. Frequent grass species include Red Fescue <i>Festuca rubra</i>, Yorkshire Fog <i>Holcus lanatus</i>, Common Bent <i>Agrostis capillaris</i> with forbs comprising of White Clover <i>Trifolium repens</i>, Common mouse-ear chickweed <i>Cerastium fontanum</i> and Common Daisy <i>Bellis perennis</i>. However, in compartment 12 the Birmingham and Black Country axiophyte Hare's-foot Clover <i>Trifolium arvense</i> is present reflecting the secondary post-industrial nature of the site.</p> <p>There are two large areas of neutral grassland that have undergone reduced management, they have developed a tussocky structure with anthills being occasionally present throughout, furthermore, compartment 5 also contained evidence of small mammal and fox use. The dominating grass species in compartment 5 are False Oat-grass <i>Arrhenatherum elatius</i>, Rough Meadow-grass <i>Poa trivialis</i>, Cocks-foot and Soft Brome <i>Bromus hordeaceus</i>. Forbs include Bramble, Common Ragwort <i>Jacobaea vulgaris</i>, Broadleaved Dock <i>Rumex obtusifolius</i>, Hairy Tare <i>Vicia hirsuta</i> and Creeping Thistle. The species composition in compartment 11 is similar to that of compartment 5.</p>			

Phase 1 Name	Introduced Shrub	Phase 1 Code	J14
Introduced shrub is occasionally present across the site. In compartment 10, present as planting amongst hard-standing is a small area dominated by Rose of Sharon, shaded by a line of Norway Maple trees. Another isolated area of introduced planting forms an edge between an area of hard-standing and car parking facilities. Here the ornamental bush is a mix of introduced and native species including, Cotoneaster, <i>Pyracantha sp</i> and Cherry Laurel <i>Prunus laurocerasus</i> .			
Phase 1 Name	Intact Hedgerow, Hedgerow with Trees	Phase 1 Code	J21, J23
All hedgerows onsite are formed of introduced species, causing them to lack ecological value and not be an example of a Habitat of Principal Importance. A mature Cherry Laurel hedge forms a border between the plantation woodland and amenity grassland. Common Lime and Field Maple trees are present throughout heavily shading the hedge and its field-layer, with only competitive species including Common Nettle, Bramble and White Bryony <i>Bryonia alba</i> being present amongst the Laurel. Within compartment 12 is a small Conifer hedgerow forming part of the heavily managed amenity grassland. One other hedgerow is present in compartment 13 and it separates a large area of amenity grassland, it is comprised entirely of Garden Privet <i>Ligustrum ovalifolium</i> .			
Notes			

Habitats of Note [2]						
Phase 1 Name	Phase 1 Code	EHD	NERC	LBAP	Rarity	Year
Hedgerows (Intact, with trees)	J21, J23		Y			2019
Notes						

Species of Note [2]								
Flora								
Species	Statutory	NERC	LBAP	RDL	Rarity	Axiophyte	Year	
<i>Brachypodium sylvaticum</i> - False-brome					F	BBCF_Ax	2019	
<i>Hyacinthoides non-scripta</i> - Bluebell	WCA8		Y		C		2019	
<i>Primula vulgaris</i> - Primrose					U		2019	
<i>Trifolium arvense</i> - Hare's-foot Clover					F	BBCF_Ax	2019	
Notes								
Fauna								
Species	Statutory	NERC	LBAP	RDL	Concern	Rarity	Year	
<i>Tyria jacobaeae</i> - Cinnabar		Y				C	2019	
<i>Columba oenas</i> - Stock Dove				BAmb		F	2019	
<i>The following Species of Note have been recorded within 500m of the assessment site boundary.</i>								
<i>Arvicola amphibious</i> - European Water Vole	WCA5/9.4 .a, WCA5/9.4 b	Y		MS_St atus_ Dec		C	2013	
Notes								

Site/Habitat Suitability for Other Species of Note (not recorded during the survey)	
Description/Notes	The semi-mature trees along with roost features present on infrastructure provide suitable roosting habitat for multiple bat species, especially due to the sites close proximity to the canal network. Furthermore, the tussocky grassland bordering the canal provides foraging for small mammals using the water way, of note is the European Water Vole <i>Arvicola amphibious</i> which has been recorded in very close proximity to the site.

Invasive Species [3]			
Species	Location	Abundance (DAFOR)	Year Recorded
<i>Rhododendron ponticum</i> - Rhododendron	Compartment 1	O	2019
Notes			

Geology	
Solid/Drift Formation	Pennine Lower Coal Measures Formation - Mudstone, Siltstone and Sandstone, with Glaciofluvial Deposits, Devensian - Sand And Gravel.
Description	Sedimentary Bedrock formed approximately 318 to 319 million years ago in the Carboniferous Period. Local environment previously dominated by swamps, estuaries and deltas.
Features of Value	
1	None Recorded.

Soils	
Slowly permeable seasonally wet slightly acid but base-rich loamy and clayey soils.	

Public Access & Site Usage	
Land Use	Grounds to Hospital facility.
Access Level	Restricted.
Access Type(s)	Private grounds.

Comparison with Previous Survey(s) Results	
No previous survey data is available for comparison.	

Summary of Assessment	
When assessed against the Local Site criteria Land at Former Goscote Hospital Site scores 'medium' or 'high' for over half of the ecological criteria and therefore meets the threshold to be designated as a SLINC. The majority of the onsite ecological value and connectivity of the site is attributed to the woodlands, planted approximately 90 years ago, and the tall neutral grassland that borders the Wyrley and Essington Canal SLINC in the east of the survey area. As such these areas depicted on 'map 1' are recommended to form a new site 'Goscote Hospital Woods'.	

Recommendations (including further survey & site management/enhancement)	
1	Woodland blocks would benefit from thinning and the addition of Hazel to allow native flora to compete with competitive species. Additionally, large areas of Bramble scrub dominating the woodland floor should be selectively cut back outside of nesting bird season.
2	The two areas of neutral grassland would increase floristically if an annual cut and removal was implemented. Large areas of scrub should also be annually managed to prevent succession changing the habitat type. In areas containing anthills a strimmer or brushcutter could be used to reduce disturbance.
3	Areas of amenity grassland and introduced shrub would be of greater value to wildlife if invasive shrubs were replaced with native woody and vascular species.
4	Bird and Bat boxes and insect hotels would provide useful nesting and hibernation opportunities for wildlife as well as being of aesthetic value to the maintained grounds.

Data Sources		
	Source	Date
Species and Habitat Data Source(s)	Ecorecord data search 2019	22/08/2019
Geological Data Source(s)	British Geological Society 1:50,000 bedrock & superficial deposits GIS web map services from BGS website: https://www.bgs.ac.uk/data/services/mash-ups/desktopgis.html	06/02/2020
Soil Data Source(s)	Soilscapes, Cranfield Soil & Agricultural Institute website: http://www.landis.org.uk/soilscapes/	06/02/2020
Historic Data Sources(s)	Ordnance Survey Country Series Mapping Black Country Historic Landscape Characterisation, Wolverhampton City Council, 2009 (updated 2010): https://archaeologydataservice.ac.uk/archives/view/blackcountry_hlc_2009/	06/02/2020

[1] Definitions of Local Sites in B&BC (SINCs & SLINCs) and Potential Sites of Importance (PSIs)

In Birmingham and the Black Country Local Wildlife and Geological Sites encompass what are termed Sites of Importance for Nature Conservation (SINCs) and Sites of Local Importance for Nature Conservation (SLINCs). This two-tier system aims to ensure that all sites of substantive local nature conservation and geological value are selected by assessing sites in both a sub-regional (i.e. Birmingham and the Black Country) and metropolitan borough or city context (either Birmingham, Dudley, Sandwell, Walsall or Wolverhampton). The two designations are defined as:

- Site of Importance for Nature Conservation (SINC) - Sites of substantive nature conservation value in the context of Birmingham and the Black Country.
- Site of Local Importance for Nature Conservation (SLINC) - Sites of substantive nature conservation value in the context of a metropolitan borough.

Potential Sites of Importance (PSIs) have not yet been assessed against the Local Wildlife and Geological Sites selection criteria but may potentially support species of note, areas of important semi-natural habitat or valuable geological features. PSIs are identified primarily through the use of aerial photography, but also through reference to old maps, existing records and local knowledge. Commonly these sites will not have been subject to the survey work necessary to undertake a Local Wildlife and Geological Sites assessment.

[2] Habitats/Species of Note Tables – Attribute Definitions

STATUTORY (PROTECTED) - *EHD* = EU Habitats Directive (plus where relevant the Annex II or IV) | *WCA S1* = Wildlife & Countryside Act Schedule 1 (birds protected at all times) | *WCA S5* = Wildlife & Countryside Act Schedule 5 (animals with various levels of protection) | *WCA S8* = Wildlife & Countryside Act Schedule 8 (higher and lower plants with various levels of protection) | *PBA* = Protection of Badgers Act 1992 | *HabRegs2* = The Conservation (Natural Habitats, &c.) Regulations 2010 (Schedule 2) | *HabRegs4* = The Conservation (Natural Habitats, &c.) Regulations 2010 (Schedule 4).

NERC – *Y* = Habitats/Species included on the current list of Principal Importance in England under Section 41 of the NERC Act (2006 or amended).

LBAP – *Y* = Habitats/Species included on the latest B&BC LBAP list of Priority Habitats/Species.

RDL - Species included on Global IUCN & British Red Data Lists: *RLGB.EN* = IUCN (2001) – Endangered | *RLGB.VU* = IUCN (2001) – Vulnerable | *RDBGB.R* = IUCN (pre 1994) – Rare | *RLGB.Lr(NT)* = IUCN (2001) - Lower risk - near threatened | *RDBGB.IK* = RDB - Insufficient known | *RLGB.DD* = IUCN (2001) - Data Deficient

RARITY (HABITATS) - BIRMINGHAM & BLACK COUNTRY - **Y**= Habitats included on the B&BC list of locally rare habitats (administered by EcoRecord).

RARITY (FLORA SPECIES) - BIRMINGHAM & BLACK COUNTRY - (based on data held and managed by EcoRecord): **VR** = Very Rare - a species present in less than 1.0% of 1Km squares, tetrads, or 5Km squares in B&BC | **R** = Rare - a species present in 1.0% - 4.3% of 1Km squares, tetrads, or 5Km squares in B&BC | **U** = Uncommon - a species present in 4.3% - 12% of 1Km squares, tetrads or 5Km squares in B&BC | **NRR** = no recent B&BC records.

AXIOPHYTE - BBCF_Ax = included on the Birmingham & the Black Country list of axiophytes (administered by EcoRecord).

YEAR - The most recent year the species has been recorded.

CONCERN (FAUNA SPECIES OF CONSERVATION CONCERN) -

Birds: **BRed** = Birds of Conservation Concern Red List - bird species of high conservation priority needing urgent conservation action. This encompasses species that are Globally Threatened according to the International Union for Nature Conservation criteria; those whose population or range has declined rapidly in recent years; and those that have declined historically and not shown a substantial recent recovery. **BAmb** = Bird of Conservation Concern Amber List – bird species with an unfavourable conservation status in Europe; those whose population or range has declined moderately in recent years; those whose population has declined historically but made a substantial recent recovery; rare breeders; and those with internationally important or localised populations.

[3] Species listed on Schedule 9 part 1 (animals) and part 2 (plants) of the Wildlife and Countryside Act 1981 as amended - this lists animals which may not be released or allowed to escape into the wild and plants which may not be planted or otherwise caused to grow in the wild.

Map 1: Land at Former Goscote Hospital Site Current & Recommended Designation

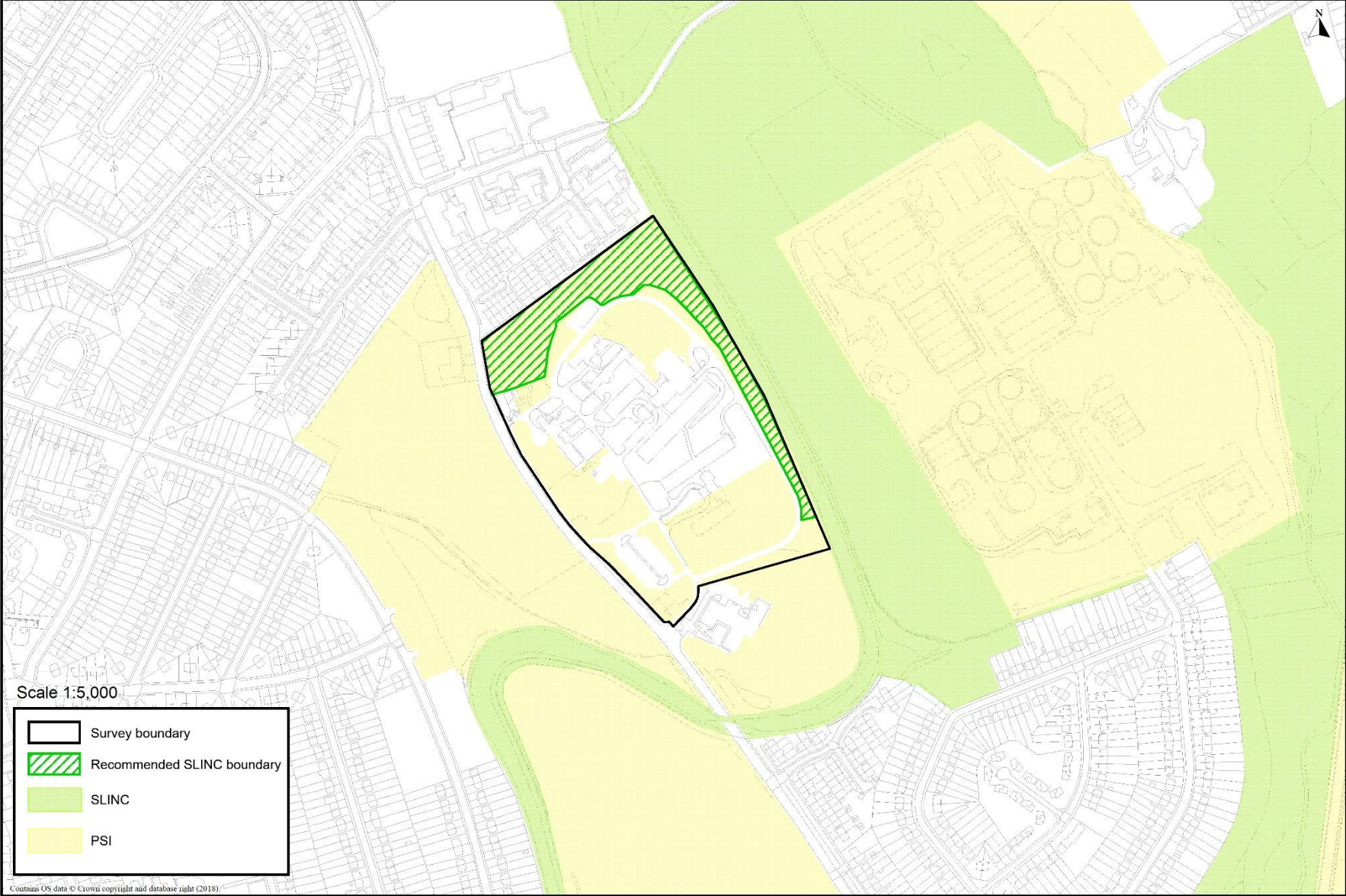

Map 2: Land at Former Goscote Hospital Site - 22.08.2019



Scale 1:2500

Contains OS data © Crown copyright and database right (2018)



Map 3: Land at Former Goscote Hospital Site Phase 1 Habitat Map Overview - 06.02.2020





Map 4: Land at Former Goscote Hospital Compartments 1,2,3,4,5,13,14,15,16,17 - 06.02.2020

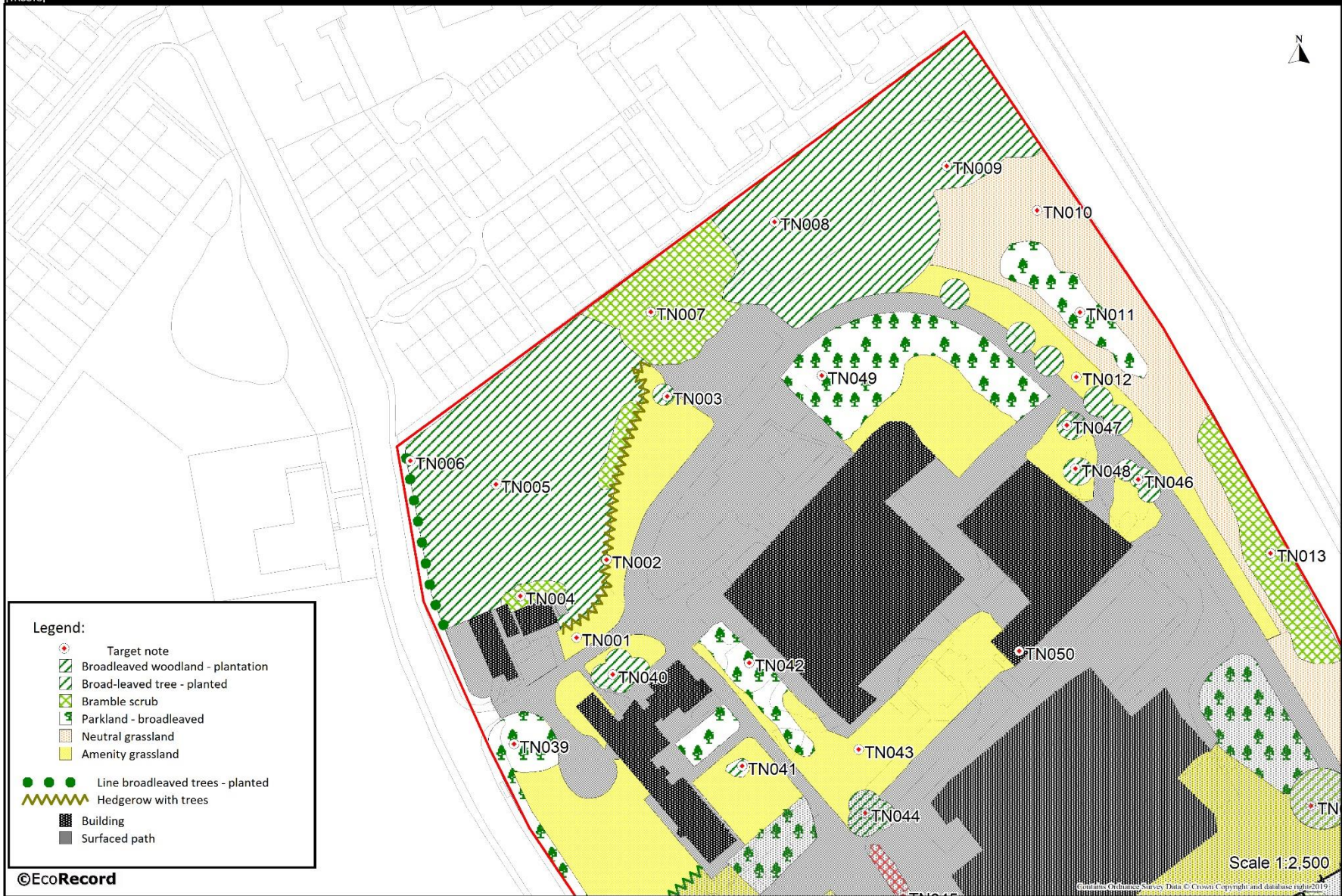



Map 5: Land at Former Goscote Hospital Compartments 6,7,8,9,10,11,12,13- 06.02.2020



Target Notes

Target Note Ref.	Target Note Description
TN001	Amenity grassland dominated by Red Fescue, White Clover and Common Chickweed.
TN002	Cherry Laurel hedgerow with Ivy underneath. Semi-mature Field Maple and Common Limes are frequent in the hedgerow.
TN003	Immature Goat Willow.
TN004	Bramble scrub with Common Nettle, Red Campion, Broadleaved Dock and Large Bindweed.
TN005	Plantation woodland dominated by Beech and Wild Cherry with an understory of Holly, Elder and Rose. The field layer includes False-brome, Bluebell, Ivy and Hedge woundwort.
TN006	Line of Sycamore and Horse Chestnut trees run along fenced road edge, the field-layer is dominated by grasses including Cocks-foot with Common Nettle.
TN007	Large area of scrub dominated by Bramble.
TN008	Woodland block with a canopy of Silver Birch, Norway Maple and Sycamore with natural regeneration of Ash and Sycamore. Field-layer has large area locally dominated with Herb Robert.
TN009	This area is dominated by Wild Cherry with a limited understory of Hawthorn, Hazel with Ash and Sycamore regeneration.
TN010	Tussocky grassland with frequent Ant hills. High grass to forb ratio with False Oat-grass, Rough Meadow-grass, Soft Brome and Cocks-foot.
TN011	Planted Birch and Field Maple trees approximately 10 years old with Oak saplings.
TN012	Heavily managed grassland with planted Common Lime and Norway Maple trees.
TN013	Bramble scrub with Elder, Creeping Thistle and Common Nettle.
TN014	Line of Scots Pine trees atop unmanaged grassland.
TN015	Scattered Beech trees with Dog-rose, Ivy and Herb Robert dominating the field-layer.
TN016	Roadside trees include Scots Pine, Rowan, Norway Maple and Wild Cherry.
TN017	Scattered Hawthorn and Norway Maple with a short sward underneath.
TN019	Derelict house with fire damage.
TN019	Row of Lombardy Poplars running along wooden fence boundary.
TN020	Field-layer dominated by Ivy and Bramble.
TN021	Line of Norway Maple trees with a field-layer of Rose of Sharon.
TN022	Carpark surrounded by palisade fencing and razor wire.
TN023	Lines of Norway Maple and Common Lime with a field-layer of Rough Meadow-grass, Wood Avens, Common Nettle and American Willowherb.
TN024	Immature scattered Silver Birch trees.
TN025	Area locally dominated by Broom.
TN026	Bergenia and Silver Birch scrub.
TN027	Broom scrub.
TN028	Three planted Maples.
TN029	Semi-mature Wild Cherry, Elder, Copper Beech with Bramble and Broom scrub.
TN030	Common Lime.
TN031	Beech.
TN032	Unmanaged grassland with successional growth taking place. Multiple anthills and mammal tracks present throughout.
TN033	Enclosed amenity grassland area that is heavily managed.
TN034	Mature Scots Pine.
TN034	Newly planted trees including Hazel.
TN036	Managed grassland with Wall Barley, Creeping Buttercup, Yorkshire Fog and Common Bent.
TN037	Planted Scots Pine, Wild Cherry, Beech and Blackthorn.
TN038	Garden Privet hedgerow.

TN039	Scattered Beech trees.
TN040	Three Beech trees and a Sycamore above heavily managed grassland with a high moss content.
TN041	Managed Field maple and Hazel bush.
TN042	Scattered trees include Copper Birch, Beech, Common Lime, Wild Cherry and Ash.
TN043	Grassland with short sward length, species include Yarrow, Creeping Cinquefoil and Lesser Trefoil.
TN045	Ornamental shrubs.
TN044	Common Lime and Pine trees above grassland dominated by Bush Vetch.
TN046	Three Silver Birch trees.
TN047	Maple tree
TN048	Silver Birch.
TN049	Scattered trees dominated by Common Lime.
TN050	Hole in roof providing potential for Bat roost.

Site Photographs



Photograph 1: Broadleaved plantation woodland that comprises compartment 2.



Photograph 2: Neutral grassland with scattered Birch trees present in compartment 5 that is adjacent to the canal on the eastern boundary.



Photograph 3: House with fire damage surrounded by scattered trees.



Photograph 4: Grassland with scrub encroachment that forms compartment 11.



Photograph 5: Heavily managed grassland with surrounding scattered trees.



Photograph 6: Target Note 50 showing potential bat roost potential.

Species Records

FLORA

Compartment 1 (Amenity grass and edge/trees)

Scientific Name	Common Name
<i>Acer platanoides</i>	Norway Maple
<i>Acer pseudoplatanus</i>	Sycamore
<i>Achillea millefolium</i>	Yarrow
<i>Agrostis capillaris</i>	Common Bent
<i>Anthriscus sylvestris</i>	Cow Parsley
<i>Arrhenatherum elatius</i>	False Oat-grass
<i>Bellis perennis</i>	Daisy
<i>Bryonia dioica</i>	White Bryony
<i>Cerastium fontanum</i>	Common Mouse-ear
<i>Cirsium arvense</i>	Creeping Thistle
<i>Cirsium vulgare</i>	Spear Thistle
<i>Elytrigia repens</i>	Common Couch
<i>Epilobium hirsutum</i>	Great Willowherb
<i>Festuca rubra</i>	Red Fescue
<i>Galium aparine</i>	Cleavers
<i>Geranium molle</i>	Dove's-foot Crane's-bill
<i>Geranium robertianum</i>	Herb-Robert
<i>Hedera helix</i>	Ivy
<i>Heracleum sphondylium</i>	Hogweed
<i>Holcus lanatus</i>	Yorkshire-fog
<i>Hyacinthoides non-scripta</i>	Bluebell
<i>Hypochaeris radicata</i>	Cat's-ear
<i>Picris echinoides</i>	Bristly Oxtongue
<i>Plantago lanceolata</i>	Ribwort Plantain
<i>Plantago major</i>	Greater Plantain
<i>Potentilla reptans</i>	Creeping Cinquefoil
<i>Prunella vulgaris</i>	Selfheal
<i>Prunus laurocerasus</i>	Cherry Laurel
<i>Ranunculus acris</i>	Meadow Buttercup
<i>Ranunculus repens</i>	Creeping Buttercup
<i>Rhododendron ponticum</i>	flowering plant
<i>Rubus fruticosus agg.</i>	Bramble
<i>Salix caprea</i>	Goat Willow
<i>Scorzoneroideis autumnalis</i>	Autumn Hawkbit
<i>Senecio jacobaea</i>	Common Ragwort
<i>Solanum dulcamara</i>	Bittersweet
<i>Sonchus asper</i>	Prickly Sow-thistle
<i>Taraxacum officinale agg.</i>	Dandelion
<i>Taxus baccata</i>	Yew
<i>Tilia platyphyllos x cordata = T. x europaea</i>	Lime
<i>Trifolium dubium</i>	Lesser Trefoil
<i>Trifolium repens</i>	White Clover
<i>Urtica dioica</i>	Common Nettle

Viola riviniana

Common Dog-violet

Compartment 2 (Woodland)

Scientific Name	Common Name
<i>Acer platanoides</i>	Norway Maple
<i>Acer pseudoplatanus</i>	Sycamore
<i>Aesculus hippocastanum</i>	Horse-chestnut
<i>Agrostis capillaris</i>	Common Bent
<i>Alliaria petiolata</i>	Garlic Mustard
<i>Anthriscus sylvestris</i>	Cow Parsley
<i>Arrhenatherum elatius</i>	False Oat-grass
<i>Artemisia vulgaris</i>	Mugwort
<i>Betula pendula</i>	Silver Birch
<i>Brachypodium sylvaticum</i>	False-brome
<i>Calystegia sepium</i>	Hedge Bindweed
<i>Cerastium fontanum</i>	Common Mouse-ear
<i>Cotoneaster</i>	flowering plant
<i>Dactylis glomerata</i>	Cock's-foot
<i>Fagus sylvatica</i>	Beech
<i>Festuca rubra</i>	Red Fescue
<i>Galium aparine</i>	Cleavers
<i>Geranium robertianum</i>	Herb-Robert
<i>Geum urbanum</i>	Wood Avens
<i>Hedera helix</i>	Ivy
<i>Heracleum sphondylium</i>	Hogweed
<i>Holcus lanatus</i>	Yorkshire-fog
<i>Hyacinthoides non-scripta</i>	Bluebell
<i>Ilex aquifolium</i>	Holly
<i>Ligustrum</i>	Privet
<i>Mahonia japonica</i>	flowering plant
<i>Picea</i>	Spruce
<i>Pinus sylvestris</i>	Scots Pine
<i>Prunus avium</i>	Wild Cherry
<i>Prunus laurocerasus</i>	Cherry Laurel
<i>Pteridium aquilinum</i>	Bracken
<i>Rubus fruticosus agg.</i>	Bramble
<i>Sambucus nigra</i>	Elder
<i>Silene dioica</i>	Red Campion
<i>Sorbus aucuparia</i>	Rowan
<i>Stachys sylvatica</i>	Hedge Woundwort
<i>Stellaria media</i>	Common Chickweed
<i>Taraxacum officinale agg.</i>	Dandelion
<i>Taxus baccata</i>	Yew
<i>Urtica dioica</i>	Common Nettle

Compartment 3 (Bramble)

Scientific Name	Common Name
<i>Acer platanoides</i>	Norway Maple
<i>Agrostis capillaris</i>	Common Bent

<i>Arrhenatherum elatius</i>	False Oat-grass
<i>Betula pendula</i>	Silver Birch
<i>Buddleja davidii</i>	Butterfly-bush
<i>Calystegia sepium</i>	Hedge Bindweed
<i>Epilobium hirsutum</i>	Great Willowherb
<i>Festuca rubra</i>	Red Fescue
<i>Geranium molle</i>	Dove's-foot Crane's-bill
<i>Geranium robertianum</i>	Herb-Robert
<i>Holcus lanatus</i>	Yorkshire-fog
<i>Lapsana communis</i>	Nipplewort
<i>Picris echioides</i>	Bristly Oxtongue
<i>Plantago lanceolata</i>	Ribwort Plantain
<i>Potentilla reptans</i>	Creeping Cinquefoil
<i>Rosa canina</i>	Dog-rose
<i>Rubus fruticosus agg.</i>	Bramble
<i>Salix</i>	Willow
<i>Scorzoneroidea autumnalis</i>	Autumn Hawkbit
<i>Senecio jacobaea</i>	Common Ragwort
<i>Taraxacum officinale agg.</i>	Dandelion
<i>Trifolium dubium</i>	Lesser Trefoil
<i>Trifolium pratense</i>	Red Clover
<i>Urtica dioica</i>	Common Nettle
<i>Vicia hirsuta</i>	Hairy Tare

Compartment 4 (Woodland)

Scientific Name	Common Name
<i>Acer campestre</i>	Field Maple
<i>Acer platanoides</i>	Norway Maple
<i>Alliaria petiolata</i>	Garlic Mustard
<i>Anthriscus sylvestris</i>	Cow Parsley
<i>Betula pendula</i>	Silver Birch
<i>Buddleja davidii</i>	Butterfly-bush
<i>Chamerion angustifolium</i>	Rosebay Willowherb
<i>Corylus avellana</i>	Hazel
<i>Cotoneaster</i>	flowering plant
<i>Crataegus monogyna</i>	Hawthorn
<i>Fraxinus excelsior</i>	Ash
<i>Galium aparine</i>	Cleavers
<i>Geranium robertianum</i>	Herb-Robert
<i>Geum urbanum</i>	Wood Avens
<i>Hedera helix</i>	Ivy
<i>Heracleum sphondylium</i>	Hogweed
<i>Heracleum sphondylium</i>	Hogweed
<i>Ilex aquifolium</i>	Holly
<i>Ligustrum</i>	Privet
<i>Pinus sylvestris</i>	Scots Pine
<i>Populus nigra x deltoides = P. x canadensis</i>	Hybrid Black-poplar
<i>Primula vulgaris</i>	Primrose

<i>Prunus avium</i>	Wild Cherry
<i>Prunus laurocerasus</i>	Cherry Laurel
<i>Rubus fruticosus agg.</i>	Bramble
<i>Salix</i>	Willow
<i>Sambucus nigra</i>	Elder
<i>Silene dioica</i>	Red Campion
<i>Sorbus aucuparia</i>	Rowan
<i>Taraxacum officinale agg.</i>	Dandelion
<i>Tilia platyphyllos x cordata = T. x europaea</i>	Lime
<i>Ulmus glabra</i>	Wych Elm
<i>Urtica dioica</i>	Common Nettle

Compartment 5 (Grassland)

Scientific Name	Common Name
<i>Acer campestre</i>	Field Maple
<i>Aegopodium podagraria</i>	Ground-elder
<i>Agrostis capillaris</i>	Common Bent
<i>Anthriscus sylvestris</i>	Cow Parsley
<i>Arrhenatherum elatius</i>	False Oat-grass
<i>Betula</i>	Birch
<i>Betula pendula</i>	Silver Birch
<i>Chamerion angustifolium</i>	Rosebay Willowherb
<i>Cirsium arvense</i>	Creeping Thistle
<i>Cirsium arvense</i>	Creeping Thistle
<i>Dactylis glomerata</i>	Cock's-foot
<i>Deschampsia cespitosa</i>	Tufted Hair-Grass
<i>Dryopteris filix-mas</i>	Male-fern
<i>Epilobium ciliatum</i>	American Willowherb
<i>Festuca rubra</i>	Red Fescue
<i>Fraxinus excelsior</i>	Ash
<i>Galium aparine</i>	Cleavers
<i>Heracleum sphondylium</i>	Hogweed
<i>Holcus lanatus</i>	Yorkshire-fog
<i>Hyacinthoides non-scripta</i>	Bluebell
<i>Lactuca serriola</i>	Prickly Lettuce
<i>Lonicera periclymenum</i>	Honeysuckle
<i>Pinus sylvestris</i>	Scots Pine
<i>Plantago lanceolata</i>	Ribwort Plantain
<i>Prunus avium</i>	Wild Cherry
<i>Quercus robur</i>	Pedunculate Oak
<i>Rosa canina</i>	Dog-rose
<i>Rubus fruticosus agg.</i>	Bramble
<i>Rumex acetosa</i>	Common Sorrel
<i>Rumex obtusifolius</i>	Broad-leaved Dock
<i>Sambucus nigra</i>	Elder
<i>Sambucus nigra</i>	Elder
<i>Senecio jacobaea</i>	Common Ragwort
<i>Urtica dioica</i>	Common Nettle

Vicia hirsuta

Hairy Tare

Compartment 6 (Grassland - short)

Scientific Name	Common Name
<i>Achillea millefolium</i>	Yarrow
<i>Agrostis capillaris</i>	Common Bent
<i>Bellis perennis</i>	Daisy
<i>Cerastium fontanum</i>	Common Mouse-ear
<i>Cirsium arvense</i>	Creeping Thistle
<i>Dactylis glomerata</i>	Cock's-foot
<i>Festuca rubra</i>	Red Fescue
<i>Geranium molle</i>	Dove's-foot Crane's-bill
<i>Heracleum sphondylium</i>	Hogweed
<i>Holcus lanatus</i>	Yorkshire-fog
<i>Hypochaeris radicata</i>	Cat's-ear
<i>Lathyrus</i>	flowering plant
<i>Lolium perenne</i>	Perennial Rye-grass
<i>Lotus corniculatus</i>	Common Bird's-foot-trefoil
<i>Plantago lanceolata</i>	Ribwort Plantain
<i>Prunella vulgaris</i>	Selfheal
<i>Ranunculus acris</i>	Meadow Buttercup
<i>Ranunculus repens</i>	Creeping Buttercup
<i>Rumex acetosa</i>	Common Sorrel
<i>Rumex obtusifolius</i>	Broad-leaved Dock
<i>Scorzoneroïdes autumnalis</i>	Autumn Hawkbit
<i>Senecio jacobaea</i>	Common Ragwort
<i>Sonchus asper</i>	Prickly Sow-thistle
<i>Sorbus aucuparia</i>	Rowan
<i>Taraxacum officinale agg.</i>	Dandelion
<i>Tilia platyphyllos x cordata = T. x europaea</i>	Lime
<i>Trifolium dubium</i>	Lesser Trefoil
<i>Trifolium repens</i>	White Clover

Compartment 7 (Scattered mature trees)

Scientific Name	Common Name
<i>Acer platanoides</i>	Norway Maple
<i>Achillea millefolium</i>	Yarrow
<i>Agrostis capillaris</i>	Common Bent
<i>Alliaria petiolata</i>	Garlic Mustard
<i>Anthriscus sylvestris</i>	Cow Parsley
<i>Anthriscus sylvestris</i>	Cow Parsley
<i>Bellis perennis</i>	Daisy
<i>Cerastium fontanum</i>	Common Mouse-ear
<i>Digitalis purpurea</i>	Foxglove
<i>Fagus sylvatica</i>	Beech
<i>Festuca rubra</i>	Red Fescue
<i>Geranium robertianum</i>	Herb-Robert
<i>Hedera helix</i>	Ivy

<i>Heracleum sphondylium</i>	Hogweed
<i>Hieracium</i>	Hawkweed
<i>Holcus lanatus</i>	Yorkshire-fog
<i>Hypochaeris radicata</i>	Cat's-ear
<i>Ilex aquifolium</i>	Holly
<i>Lolium perenne</i>	Perennial Rye-grass
<i>Lotus corniculatus</i>	Common Bird's-foot-trefoil
<i>Pinus</i>	Deal
<i>Pinus sylvestris</i>	Scots Pine
<i>Plantago lanceolata</i>	Ribwort Plantain
<i>Prunus avium</i>	Wild Cherry
<i>Ranunculus acris</i>	Meadow Buttercup
<i>Ranunculus repens</i>	Creeping Buttercup
<i>Sambucus nigra</i>	Elder
<i>Scorzoneroidea autumnalis</i>	Autumn Hawkbit
<i>Senecio jacobaea</i>	Common Ragwort
<i>Sonchus asper</i>	Prickly Sow-thistle
<i>Sonchus oleraceus</i>	Smooth Sow-thistle
<i>Sorbus aucuparia</i>	Rowan
<i>Taraxacum officinale agg.</i>	Dandelion
<i>Trifolium dubium</i>	Lesser Trefoil
<i>Trifolium pratense</i>	Red Clover
<i>Trifolium repens</i>	White Clover
<i>Urtica dioica</i>	Common Nettle
<i>Vicia hirsuta</i>	Hairy Tare
<i>Viola riviniana</i>	Common Dog-violet

Compartment 8 (Scattered trees)

Scientific Name	Common Name
<i>Acer platanoides</i>	Norway Maple
<i>Achillea millefolium</i>	Yarrow
<i>Achillea millefolium</i>	Yarrow
<i>Agrostis capillaris</i>	Common Bent
<i>Anthriscus sylvestris</i>	Cow Parsley
<i>Artemisia absinthium</i>	Wormwood
<i>Artemisia vulgaris</i>	Mugwort
<i>Bromus hordeaceus</i>	Lesser Soft-Brome
<i>Cerastium fontanum</i>	Common Mouse-ear
<i>Cirsium arvense</i>	Creeping Thistle
<i>Corylus avellana</i>	Hazel
<i>Crataegus monogyna</i>	Hawthorn
<i>Dactylis glomerata</i>	Cock's-foot
<i>Epilobium ciliatum</i>	American Willowherb
<i>Festuca rubra</i>	Red Fescue
<i>Geum urbanum</i>	Wood Avens
<i>Hedera helix</i>	Ivy
<i>Holcus lanatus</i>	Yorkshire-fog
<i>Hypochaeris radicata</i>	Cat's-ear
<i>Laburnum anagyroides</i>	Laburnham

<i>Lolium perenne</i>	Perennial Rye-grass
<i>Picris echioides</i>	Bristly Oxtongue
<i>Plantago lanceolata</i>	Ribwort Plantain
<i>Plantago major</i>	Greater Plantain
<i>Ranunculus acris</i>	Meadow Buttercup
<i>Ranunculus repens</i>	Creeping Buttercup
<i>Rubus fruticosus agg.</i>	Bramble
<i>Rumex acetosella</i>	Sheep's Sorrel
<i>Silene dioica</i>	Red Campion
<i>Sonchus oleraceus</i>	Smooth Sow-thistle
<i>Taraxacum officinale agg.</i>	Dandelion
<i>Trifolium dubium</i>	Lesser Trefoil
<i>Trifolium repens</i>	White Clover
<i>Veronica chamaedrys</i>	Germander Speedwell
<i>Viola riviniana</i>	Common Dog-violet
<i>Viola riviniana</i>	Common Dog-violet

Compartment 9 (House/garden)

Scientific Name	Common Name
<i>Acer pseudoplatanus</i>	Sycamore
<i>Aesculus hippocastanum</i>	Horse-chestnut
<i>Agrostis capillaris</i>	Common Bent
<i>Berberis vulgaris</i>	Barberry
<i>Bromus hordeaceus</i>	Lesser Soft-Brome
<i>Cornus sanguinea</i>	Dogwood
<i>Crataegus monogyna</i>	Hawthorn
<i>Epilobium ciliatum</i>	American Willowherb
<i>Fraxinus excelsior</i>	Ash
<i>Hedera helix</i>	Ivy
<i>Holcus lanatus</i>	Yorkshire-fog
<i>Lactuca serriola</i>	Prickly Lettuce
<i>Ligustrum ovalifolium</i>	Garden Privet
<i>Medicago lupulina</i>	Black Medick
<i>Populus nigra 'Italica'</i>	Lombardy-Poplar
<i>Quercus robur</i>	Pedunculate Oak
<i>Rubus fruticosus agg.</i>	Bramble
<i>Symphoricarpos albus</i>	Snowberry
<i>Tragopogon pratensis</i>	Goat's-beard
<i>Viburnum opulus</i>	Gelder-rose

Compartment 10 (Car park/compound)

Scientific Name	Common Name
<i>Acer platanoides</i>	Norway Maple
<i>Acer pseudoplatanus</i>	Sycamore
<i>Achillea millefolium</i>	Yarrow
<i>Aesculus hippocastanum</i>	Horse-chestnut
<i>Agrostis capillaris</i>	Common Bent
<i>Anthriscus sylvestris</i>	Cow Parsley
<i>Arrhenatherum elatius</i>	False Oat-grass

<i>Artemisia vulgaris</i>	Mugwort
<i>Betula pendula</i>	Silver Birch
<i>Chamerion angustifolium</i>	Rosebay Willowherb
<i>Cirsium vulgare</i>	Spear Thistle
<i>Cirsium vulgare</i>	Spear Thistle
<i>Cotoneaster</i>	flowering plant
<i>Crataegus monogyna</i>	Hawthorn
<i>Dactylis glomerata</i>	Cock's-foot
<i>Digitalis purpurea</i>	Foxglove
<i>Epilobium ciliatum</i>	American Willowherb
<i>Epilobium hirsutum</i>	Great Willowherb
<i>Fagus sylvatica</i>	Beech
<i>Festuca rubra</i>	Red Fescue
<i>Fraxinus excelsior</i>	Ash
<i>Geranium lucidum</i>	Shining Crane's-bill
<i>Geum urbanum</i>	Wood Avens
<i>Hibiscus syriacus</i>	Syrian Ketmia
<i>Hieracium</i>	Hawkweed
<i>Holcus lanatus</i>	Yorkshire-fog
<i>Hypochaeris radicata</i>	Cat's-ear
<i>Laburnum anagyroides</i>	Laburnham
<i>Medicago lupulina</i>	Black Medick
<i>Persicaria maculosa</i>	Redshank
<i>Pinus sylvestris</i>	Scots Pine
<i>Plantago lanceolata</i>	Ribwort Plantain
<i>Prunus avium</i>	Wild Cherry
<i>Prunus laurocerasus</i>	Cherry Laurel
<i>Quercus robur</i>	Pedunculate Oak
<i>Ranunculus acris</i>	Meadow Buttercup
<i>Ranunculus repens</i>	Creeping Buttercup
<i>Rubus fruticosus agg.</i>	Bramble
<i>Sambucus nigra</i>	Elder
<i>Senecio jacobaea</i>	Common Ragwort
<i>Sonchus oleraceus</i>	Smooth Sow-thistle
<i>Sorbus aucuparia</i>	Rowan
<i>Taraxacum officinale agg.</i>	Dandelion
<i>Tilia platyphyllos x cordata = T. x europaea</i>	Lime
<i>Tragopogon pratensis</i>	Goat's-beard
<i>Trifolium repens</i>	White Clover
<i>Tussilago farfara</i>	Colt's-foot
<i>Ulex europaeus</i>	Gorse
<i>Urtica dioica</i>	Common Nettle

Compartment 11

Scientific Name	Common Name
<i>Acer platanoides</i>	Norway Maple
<i>Achillea millefolium</i>	Yarrow
<i>Aesculus hippocastanum</i>	Horse-chestnut

<i>Agrostis capillaris</i>	Common Bent
<i>Anthriscus sylvestris</i>	Cow Parsley
<i>Arrhenatherum elatius</i>	False Oat-grass
<i>Bellis perennis</i>	Daisy
<i>Bergenia</i>	flowering plant
<i>Betula pendula</i>	Silver Birch
<i>Cardamine flexuosa</i>	Wavy Bitter-cress
<i>Chamerion angustifolium</i>	Rosebay Willowherb
<i>Cirsium arvense</i>	Creeping Thistle
<i>Crataegus monogyna</i>	Hawthorn
<i>Cytisus scoparius</i>	Broom
<i>Dactylis glomerata</i>	Cock's-foot
<i>Epilobium ciliatum</i>	American Willowherb
<i>Epilobium hirsutum</i>	Great Willowherb
<i>Fagus sylvatica</i>	Beech
<i>Fagus sylvatica</i> 'Purpurea'	Copper Beech
<i>Festuca rubra</i>	Red Fescue
<i>Galium aparine</i>	Cleavers
<i>Heracleum sphondylium</i>	Hogweed
<i>Holcus lanatus</i>	Yorkshire-fog
<i>Hypericum perforatum</i>	Perforate St John's-wort
<i>Plantago lanceolata</i>	Ribwort Plantain
<i>Plantago major</i>	Greater Plantain
<i>Potentilla reptans</i>	Creeping Cinquefoil
<i>Prunus avium</i>	Wild Cherry
<i>Quercus robur</i>	Pedunculate Oak
<i>Ranunculus repens</i>	Creeping Buttercup
<i>Rosa</i>	Rose
<i>Rubus fruticosus</i> agg.	Bramble
<i>Rumex obtusifolius</i>	Broad-leaved Dock
<i>Salix</i>	Willow
<i>Sambucus nigra</i>	Elder
<i>Scorzonerooides autumnalis</i>	Autumn Hawkbit
<i>Senecio jacobaea</i>	Common Ragwort
<i>Silene latifolia</i>	White Campion
<i>Sorbus aucuparia</i>	Rowan
<i>Syringa vulgaris</i>	Lilac
<i>Taraxacum officinale</i> agg.	Dandelion
<i>Tilia platyphyllos</i> x <i>cordata</i> = <i>T. x europaea</i>	Lime
<i>Trifolium repens</i>	White Clover
<i>Urtica dioica</i>	Common Nettle
<i>Vicia hirsuta</i>	Hairy Tare
<i>Vicia sativa</i>	Common Vetch
<i>Vicia sepium</i>	Bush Vetch
<i>Viola riviniana</i>	Common Dog-violet

Compartment 12 (Fenced area)

Scientific Name	Common Name
-----------------	-------------

<i>Alchemilla mollis</i>	Garden Lady's-mantle
<i>Bellis perennis</i>	Daisy
<i>Betula pendula</i>	Silver Birch
<i>Cirsium vulgare</i>	Spear Thistle
<i>Corylus avellana</i>	Hazel
<i>Epilobium ciliatum</i>	American Willowherb
<i>Equisetum arvense</i>	Field Horsetail
<i>Fagus sylvatica</i>	Beech
<i>Geranium lucidum</i>	Shining Crane's-bill
<i>Geranium molle</i>	Dove's-foot Crane's-bill
<i>Geranium robertianum</i>	Herb-Robert
<i>Hypochaeris radicata</i>	Cat's-ear
<i>Medicago lupulina</i>	Black Medick
<i>Melilotus</i>	flowering plant
<i>Prunus avium</i>	Wild Cherry
<i>Sonchus asper</i>	Prickly Sow-thistle
<i>Sorbus aucuparia</i>	Rowan
<i>Trifolium arvense</i>	Hare's-foot Clover
<i>Trifolium pratense</i>	Red Clover
<i>Trifolium repens</i>	White Clover
<i>Tripleurospermum inodorum</i>	Scentless Mayweed

Compartment 13 (Grass - short and medium and pines)

Scientific Name	Common Name
<i>Acer pseudoplatanus</i>	Sycamore
<i>Achillea millefolium</i>	Yarrow
<i>Aesculus hippocastanum</i>	Horse-chestnut
<i>Agrostis capillaris</i>	Common Bent
<i>Anthriscus sylvestris</i>	Cow Parsley
<i>Artemisia vulgaris</i>	Mugwort
<i>Bellis perennis</i>	Daisy
<i>Cerastium fontanum</i>	Common Mouse-ear
<i>Cirsium vulgare</i>	Spear Thistle
<i>Crataegus monogyna</i>	Hawthorn
<i>Dactylis glomerata</i>	Cock's-foot
<i>Epilobium ciliatum</i>	American Willowherb
<i>Epilobium hirsutum</i>	Great Willowherb
<i>Fagus sylvatica</i>	Beech
<i>Fatsia japonica</i>	flowering plant
<i>Geranium dissectum</i>	Cut-leaved Crane's-bill
<i>Holcus lanatus</i>	Yorkshire-fog
<i>Hordeum murinum</i>	Wall Barley
<i>Hypochaeris radicata</i>	Cat's-ear
<i>Ilex aquifolium</i>	Holly
<i>Ligustrum ovalifolium</i>	Garden Privet
<i>Lolium perenne</i>	Perennial Rye-grass
<i>Myosotis arvensis</i>	Field Forget-me-not
<i>Pinus sylvestris</i>	Scots Pine
<i>Plantago lanceolata</i>	Ribwort Plantain

<i>Plantago major</i>	Greater Plantain
<i>Poa annua</i>	Annual Meadow-grass
<i>Prunella vulgaris</i>	Selfheal
<i>Prunus</i>	Flowering Cherry
<i>Ranunculus repens</i>	Creeping Buttercup
<i>Rosa</i>	Rose
<i>Rumex acetosella</i>	Sheep's Sorrel
<i>Scorzoneroïdes autumnalis</i>	Autumn Hawkbit
<i>Senecio jacobaea</i>	Common Ragwort
<i>Senecio vulgaris</i>	Groundsel
<i>Sonchus asper</i>	Prickly Sow-thistle
<i>Stellaria media</i>	Common Chickweed
<i>Syringa vulgaris</i>	Lilac
<i>Taraxacum officinale agg.</i>	Dandelion
<i>Ulex europaeus</i>	Gorse
<i>Veronica chamaedrys</i>	Germander Speedwell
<i>Veronica serpyllifolia</i>	Thyme-leaved Speedwell

Compartment 14 (Amenity grass and trees)

Scientific Name	Common Name
<i>Acer pseudoplatanus</i>	Sycamore
<i>Agrostis capillaris</i>	Common Bent
<i>Cerastium fontanum</i>	Common Mouse-ear
<i>Crataegus monogyna</i>	Hawthorn
<i>Fagus sylvatica</i>	Beech
<i>Festuca rubra</i>	Red Fescue
<i>Holcus lanatus</i>	Yorkshire-fog
<i>Hyacinthoides non-scripta</i>	Bluebell
<i>Hypericum</i>	St. John's-Wort
<i>Hypochaeris radicata</i>	Cat's-ear
<i>Plantago major</i>	Greater Plantain
<i>Prunella vulgaris</i>	Selfheal
<i>Rubus fruticosus agg.</i>	Bramble
<i>Senecio jacobaea</i>	Common Ragwort
<i>Trifolium dubium</i>	Lesser Trefoil
<i>Trifolium repens</i>	White Clover

Compartment 15 (Between buildings)

Scientific Name	Common Name
<i>Acer campestre</i>	Field Maple
<i>Achillea millefolium</i>	Yarrow
<i>Agrostis capillaris</i>	Common Bent
<i>Bellis perennis</i>	Daisy
<i>Betula</i>	Birch
<i>Cirsium vulgare</i>	Spear Thistle
<i>Corylus avellana</i>	Hazel
<i>Fagus sylvatica</i>	Beech
<i>Fagus sylvatica 'Purpurea'</i>	Copper Beech
<i>Fagus sylvatica 'Purpurea'</i>	Copper Beech

<i>Festuca rubra</i>	Red Fescue
<i>Fraxinus</i>	flowering plant
<i>Holcus lanatus</i>	Yorkshire-fog
<i>Hypochaeris radicata</i>	Cat's-ear
<i>Ilex aquifolium</i>	Holly
<i>Lavandula</i>	Lavender
<i>Lotus corniculatus</i>	Common Bird's-foot-trefoil
<i>Mahonia japonica</i>	flowering plant
<i>Picris echioides</i>	Bristly Oxtongue
<i>Pinus sylvestris</i>	Scots Pine
<i>Plantago major</i>	Greater Plantain
<i>Poa trivialis</i>	Rough Meadow-grass
<i>Potentilla</i>	Cinquefoil
<i>Prunella vulgaris</i>	Selfheal
<i>Prunus</i>	Flowering Cherry
<i>Prunus avium</i>	Wild Cherry
<i>Prunus laurocerasus</i>	Cherry Laurel
<i>Ranunculus acris</i>	Meadow Buttercup
<i>Ranunculus repens</i>	Creeping Buttercup
<i>Sambucus nigra</i>	Elder
<i>Senecio vulgaris</i>	Groundsel
<i>Sonchus asper</i>	Prickly Sow-thistle
<i>Sonchus oleraceus</i>	Smooth Sow-thistle
<i>Sorbus aucuparia</i>	Rowan
<i>Stellaria media</i>	Common Chickweed
<i>Taraxacum officinale agg.</i>	Dandelion
<i>Tilia platyphyllos x cordata = T. x europaea</i>	Lime
<i>Trifolium repens</i>	White Clover
<i>Viburnum opulus</i>	Guelder-rose
<i>Viburnum tinus</i>	Laurustinus
<i>Yucca</i>	flowering plant

Compartment 16 (Watermill building)

Scientific Name	Common Name
<i>Acer platanoides 'Schwedleri'</i>	Norway Maple variety
<i>Acer pseudoplatanus</i>	Sycamore
<i>Achillea millefolium</i>	Yarrow
<i>Betula pendula</i>	Silver Birch
<i>Buddleja davidii</i>	Butterfly-bush
<i>Cirsium vulgare</i>	Spear Thistle
<i>Conyza</i>	flowering plant
<i>Cornus sanguinea</i>	Dogwood
<i>Cotoneaster</i>	flowering plant
<i>Epilobium ciliatum</i>	American Willowherb
<i>Euphorbia helioscopia</i>	Sun Spurge
<i>Geranium molle</i>	Dove's-foot Crane's-bill
<i>Hibiscus syriacus</i>	Syrian Ketmia
<i>Hypochaeris radicata</i>	Cat's-ear

<i>Liriodendron</i>	flowering plant
<i>Pinus</i>	Deal
<i>Plantago lanceolata</i>	Ribwort Plantain
<i>Plantago major</i>	Greater Plantain
<i>Prunella vulgaris</i>	Selfheal
<i>Prunus laurocerasus</i>	Cherry Laurel
<i>Pyracantha</i>	flowering plant
<i>Ranunculus repens</i>	Creeping Buttercup
<i>Salix alba</i>	White Willow
<i>Senecio jacobaea</i>	Common Ragwort
<i>Senecio vulgaris</i>	Groundsel
<i>Sonchus oleraceus</i>	Smooth Sow-thistle
<i>Sorbus</i>	Whitebeam
<i>Sorbus aucuparia</i>	Rowan
<i>Taraxacum officinale agg.</i>	Dandelion
<i>Tilia platyphyllos x cordata = T. x europaea</i>	Lime
<i>Trifolium dubium</i>	Lesser Trefoil
<i>Trifolium repens</i>	White Clover
<i>Urtica dioica</i>	Common Nettle
<i>Vicia sativa</i>	Common Vetch
<i>Vicia sepium</i>	Bush Vetch

Compartment 17

Scientific Name	Common Name
<i>Achillea millefolium</i>	Yarrow
<i>Agrostis capillaris</i>	Common Bent
<i>Anthriscus sylvestris</i>	Cow Parsley
<i>Bellis perennis</i>	Daisy
<i>Betula pendula</i>	Silver Birch
<i>Cotoneaster</i>	flowering plant
<i>Crataegus monogyna</i>	Hawthorn
<i>Epilobium ciliatum</i>	American Willowherb
<i>Euphorbia helioscopia</i>	Sun Spurge
<i>Festuca rubra</i>	Red Fescue
<i>Fumaria officinalis</i>	Common Fumitory
<i>Geranium robertianum</i>	Herb-Robert
<i>Hedera helix</i>	Ivy
<i>Holcus lanatus</i>	Yorkshire-fog
<i>Hypochaeris radicata</i>	Cat's-ear
<i>Ilex aquifolium</i>	Holly
<i>Lotus corniculatus</i>	Common Bird's-foot-trefoil
<i>Mahonia japonica</i>	flowering plant
<i>Malva sylvestris</i>	Common Mallow
<i>Papaver rhoeas</i>	Common Poppy
<i>Persicaria maculosa</i>	Redshank
<i>Plantago lanceolata</i>	Ribwort Plantain
<i>Plantago major</i>	Greater Plantain
<i>Prunus avium</i>	Wild Cherry

<i>Prunus laurocerasus</i>	Cherry Laurel
<i>Prunus spinosa</i>	Blackthorn
<i>Rosa canina</i>	Dog-rose
<i>Rosa canina</i>	Dog-rose
<i>Rumex obtusifolius</i>	Broad-leaved Dock
<i>Senecio vulgaris</i>	Groundsel
<i>Sonchus oleraceus</i>	Smooth Sow-thistle
<i>Sorbus aucuparia</i>	Rowan
<i>Taraxacum officinale agg.</i>	Dandelion
<i>Taxus baccata</i>	Yew
<i>Tilia platyphyllos x cordata = T. x europaea</i>	Lime
<i>Trifolium dubium</i>	Lesser Trefoil
<i>Trifolium repens</i>	White Clover
<i>Tripleurospermum inodorum</i>	Scentless Mayweed
<i>Vicia hirsuta</i>	Hairy Tare

FAUNA

Whole Site

Scientific Name	Common Name
<i>Opiliones</i>	harvestman (Opiliones)
<i>Pararge aegeria tircis</i>	Speckled Wood
<i>Pieris brassicae</i>	Large White
<i>Pyronia tithonus</i>	Hedge Brown
<i>Sympetrum</i>	Darter Dragonfly
<i>Sympetrum striolatum</i>	Common Darter
<i>Formicidae</i>	Invertebrates (Ants)
<i>Tyria jacobaeae</i>	Cinnabar
<i>Caelifera</i>	insect - orthopteran
<i>Gryllidae</i>	insect - orthopteran
<i>Cepaea (Cepaea) nemoralis</i>	Brown-lipped Snail
<i>Araneidae</i>	orb-weavers
<i>Aegithalos caudatus</i>	Long-tailed Tit
<i>Columba oenas</i>	Stock Dove
<i>Columba palumbus</i>	Woodpigeon
<i>Cyanistes caeruleus</i>	Blue Tit
<i>Erithacus rubecula</i>	Robin
<i>Pica pica</i>	Magpie
<i>Sitta europaea</i>	Nuthatch
<i>Troglodytes troglodytes</i>	Wren
<i>Turdus merula</i>	Blackbird
<i>Rattus norvegicus</i>	Brown Rat
<i>Sciurus carolinensis</i>	Eastern Grey Squirrel
<i>Vulpes vulpes</i>	Red Fox