

ORDERS UNDER SECTION 18 OF THE HIGHWAYS ACT 1980  
PLAN SYMBOLS

Existing highway layout where it is proposed to be altered	Highway boundary	---
	Carriageway	----
Classified Road	Highway boundary	---
	Carriageway	----
Highway to be stopped up	Highway boundary	▨
	Carriageway	▨
Highway to be improved	Highway boundary	▩
	Carriageway	▩
New Highway	Highway boundary	---
	Carriageway	----
Private means of access to be stopped		█
New means of access		▨

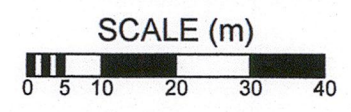
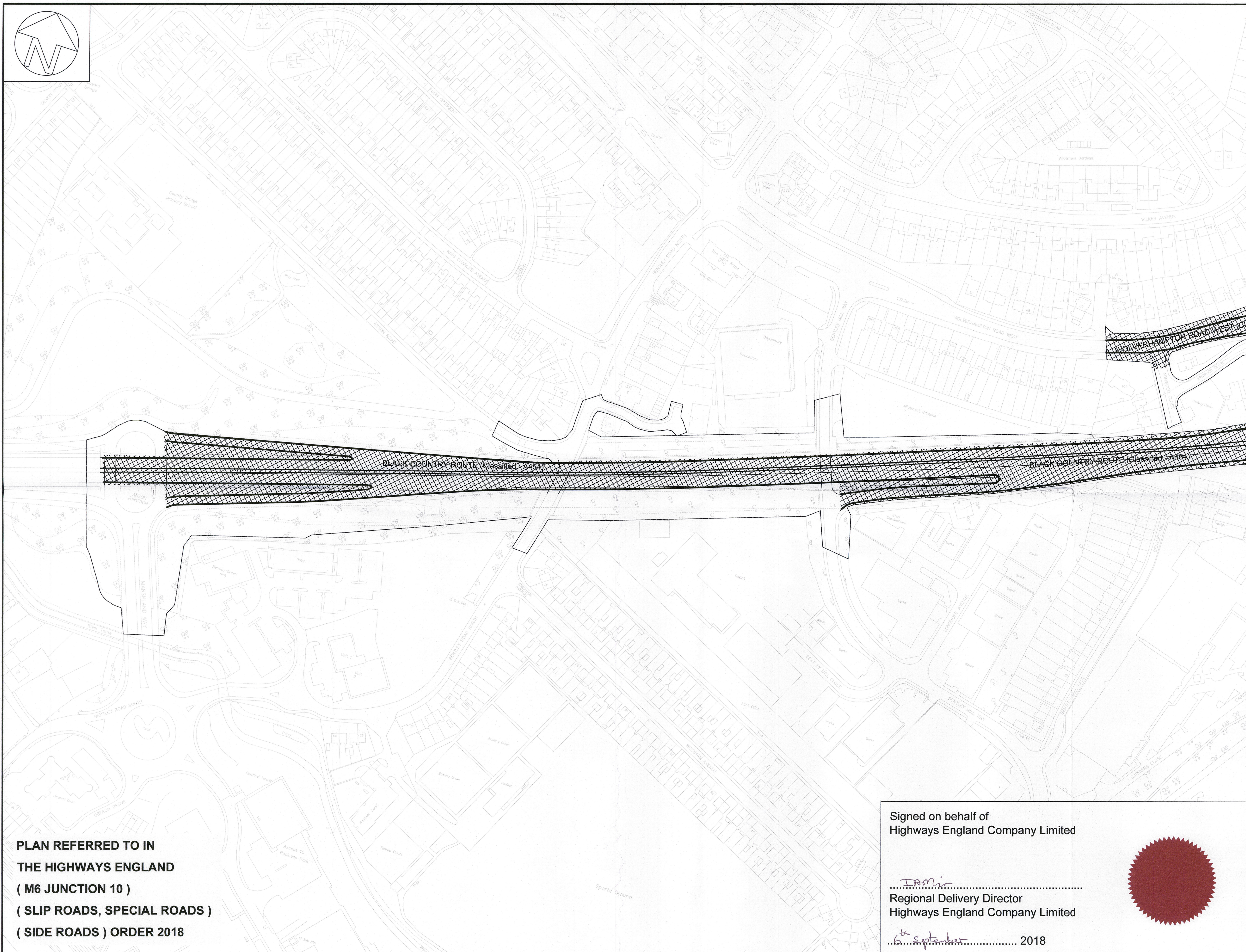

5.0	Amendments following LRS review	DJ	03/9/18
4.0	Minor amendments	DJ	15/8/18
3.0	Draft for HE review	DJ	11/7/18
2.0	Amended to reflect Weightmans comments	DJ	17/4/18
1.0	Draft for comment	DJ	5/4/18
Rev.	Comment	By	Date

Project:  
**M6 Junction 10 Alterations**

Title:  
The Highways England  
( M6 Junction 10 )  
( Slip Roads, Special Roads )  
( Side Roads ) Order 2018 - Sheet 1

Design: DJ	CAD: DJ
Chk'd: SE	App'd: MC
Date: April 2018	Scale: 1:1250 @ A1



No. MP/M6J10/SIRO-02 Rev: 5.0

PLAN REFERRED TO IN  
THE HIGHWAYS ENGLAND  
( M6 JUNCTION 10 )  
( SLIP ROADS, SPECIAL ROADS )  
( SIDE ROADS ) ORDER 2018

Signed on behalf of  
Highways England Company Limited

*D.J.M.*  
Regional Delivery Director  
Highways England Company Limited  
*6 September* 2018

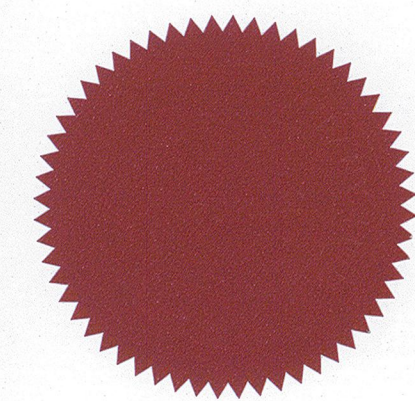



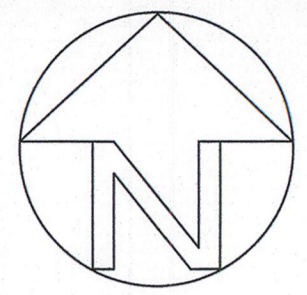

J Hill & Sons

**ORDERS UNDER SECTION 18 OF THE HIGHWAYS ACT 1980  
PLAN SYMBOLS**

Existing highway layout where it is proposed to be altered	Highway boundary	---
	Carriageway	----
Classified Road	Highway boundary	---
	Carriageway	----
Highway to be stopped up	Highway boundary	---/---
	Carriageway	---/---
Highway to be improved	Highway boundary	---/---
	Carriageway	---/---
New Highway	Highway boundary	---/---
	Carriageway	---/---
Private means of access to be stopped		---
New means of access		---/---

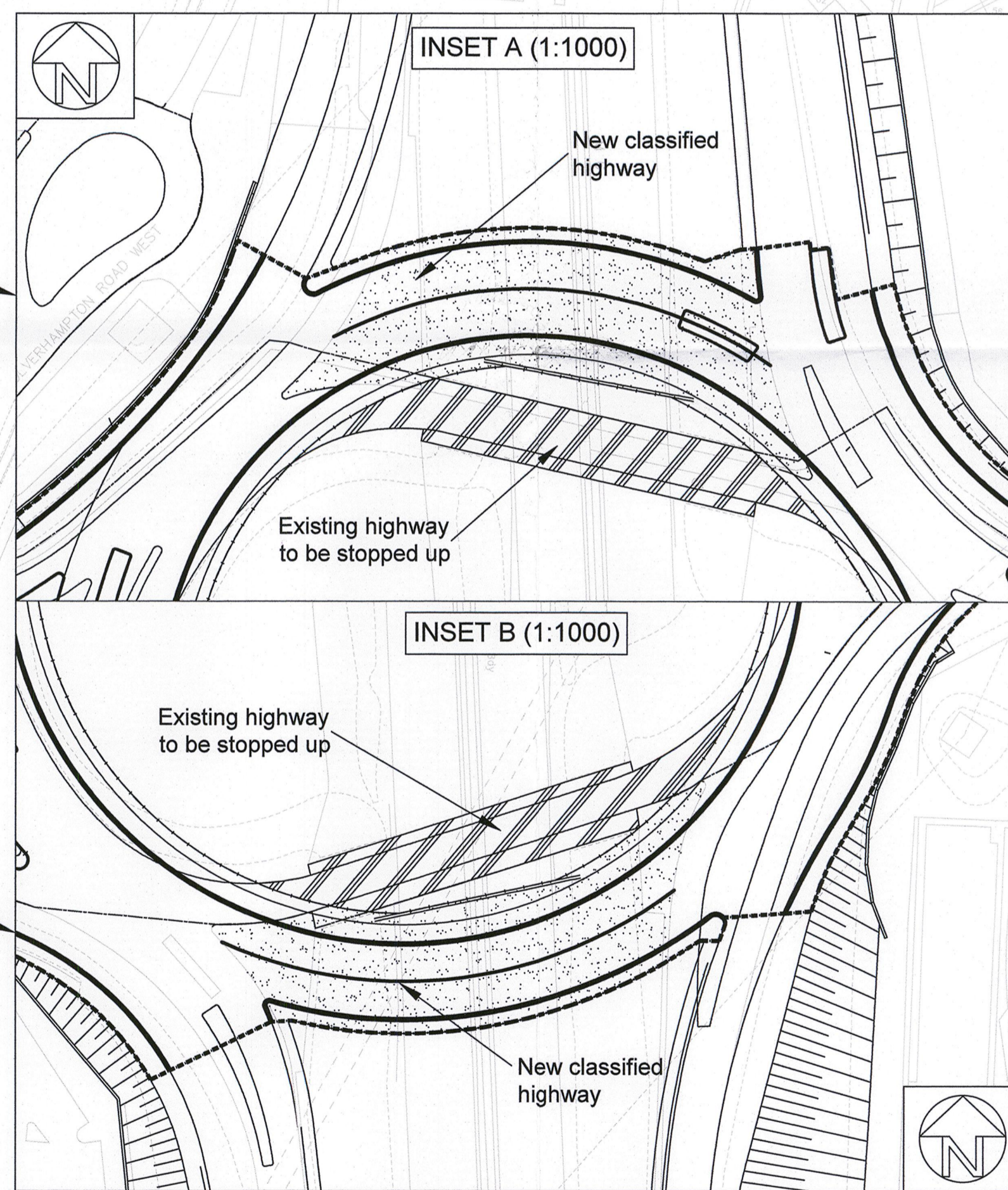
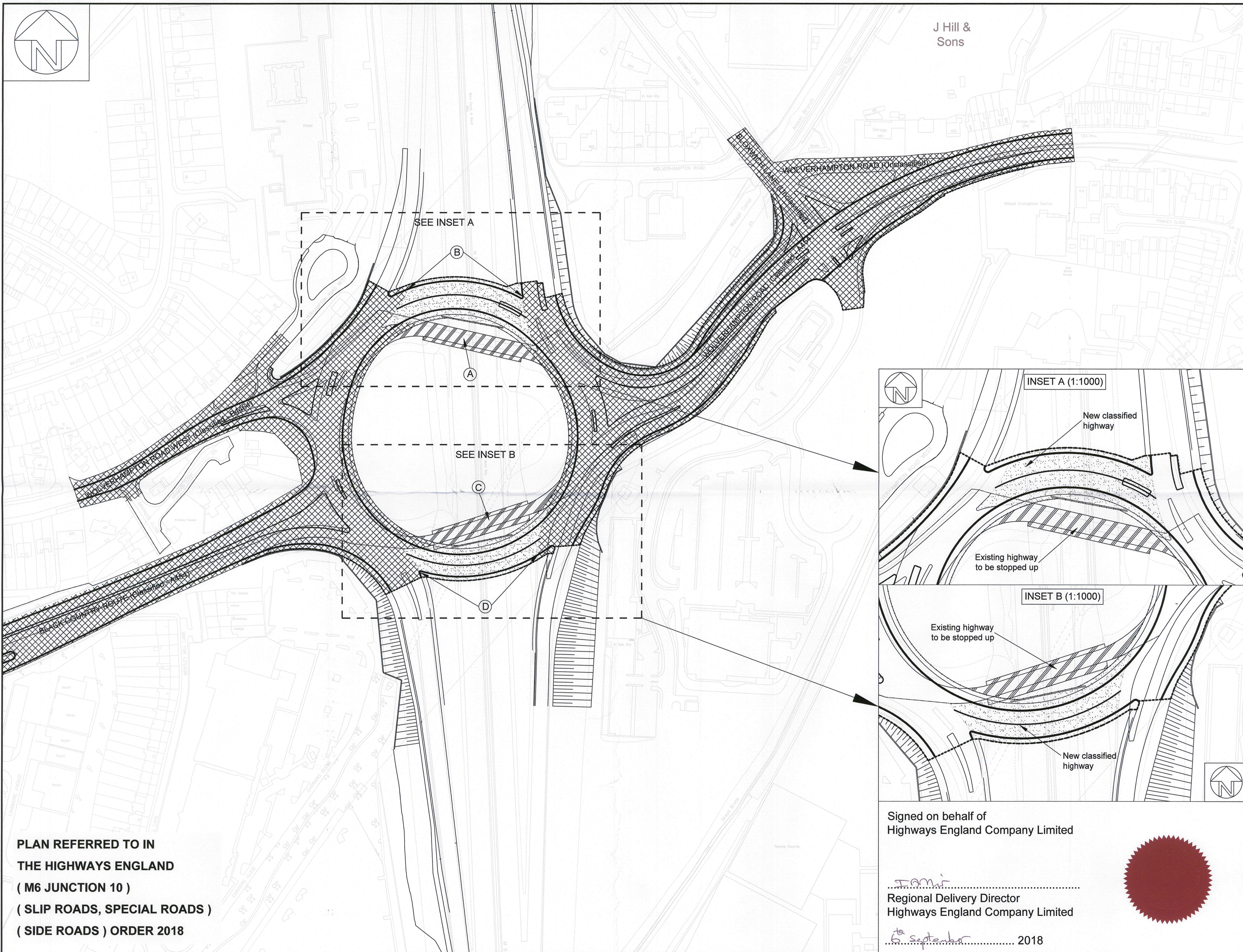

SCALE (m)  
0 5 10 20 30 40

5.0	Amendments following LRS review	DJ	03/9/18
4.0	Minor amendments	DJ	15/6/18
3.0	Draft for HE review	DJ	11/7/18
2.0	Amended to reflect Weightmans comments	DJ	17/4/18
1.0	For internal review	DJ	5/4/18
Rev.	Comment	By	Date

Project: **M6 Junction 10 Alterations**

Title: **The Highways England  
( M6 Junction 10 )  
( Slip Roads, Special Roads )  
( Side Roads ) Order 2018 - Sheet 2**

Design: DJ	CAD: DJ
Chk'd: SE	App'd: MC
Date: April 2018	Scale: 1:1250 @ A1



No. **MP/M6J10/SIRO-03** Rev: **5.0**

**PLAN REFERRED TO IN  
THE HIGHWAYS ENGLAND  
( M6 JUNCTION 10 )  
( SLIP ROADS, SPECIAL ROADS )  
( SIDE ROADS ) ORDER 2018**

Signed on behalf of  
Highways England Company Limited

*J.M.H.*  
Regional Delivery Director  
Highways England Company Limited  
*6 September* 2018

